

D62B

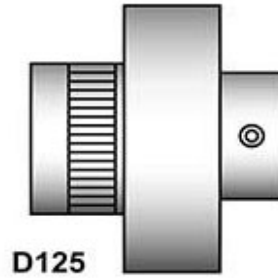
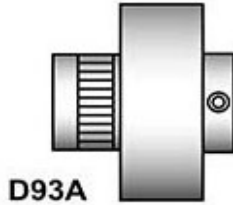
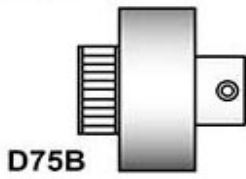
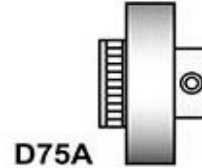
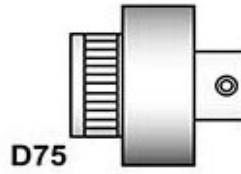
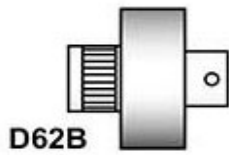
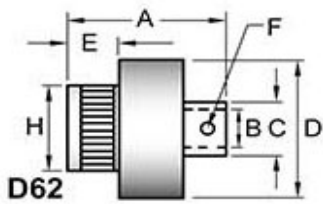

Tiny-Clutch D62 D-Series Roller Clutch

Specifications:

Max Torque	5 in/lbs
Max Speed	7000 rpm
Dimension A	0.84 in
Dimension C	0.31 in
Dimension D	0.81 in
Dimension E	0.28 in
Dimension H	0.375 in
	0.373 in

Options:

Bore	1/8", 3/16", 1/4", 3mm, 4mm, 5mm
	6mm
Mounting	Set Screw, CrossHole
	Set Screw & Cross Hole
Drive	Clockwise, Counter Clockwise

Tiny-Clutch | Helander Products, Inc.

www.TinyClutch.com

TinyClutch@HelanderProducts.com

860.669.7953